

icon[®]
DIGITAL CLINICAL SCALES

**STATE-OF-THE-ART
EYE-LEVEL
DIGITAL
CLINICAL
SCALES**

- Extra-high 1,000-lb capacity
- Sonar touchless height rod for ultimate speed and accuracy
- Ultra-thin platform only 1.5 inches high
- Multi-color touchscreen LCD display
- Displays weight, height, and BMI onscreen simultaneously



**WEIGHT, HEIGHT + BMI
INSTANT READOUTS
WITHOUT PUSHING
A SINGLE BUTTON**

The icon's powerful sonar touchless height rod combined with an all-in-one color display means the patient simply steps onto the scale platform and within a second your full measurements are all displayed onscreen instantly without having to press a single key for the ultimate in speed, hygiene, and accuracy.



THE NEXT EVOLUTION OF CLINICAL PATIENT MEASUREMENT HAS ARRIVED!

MINIMAL STEP

The icon's virtually-flat base is only 1.5 inches high, offering the ultimate in patient ease of use and comfort while weighing. Plus, the extra-wide 17 inch wide by 17 inch deep platform size allows bariatric weighing.

USA-MADE, STATE-OF-THE-ART MEASUREMENT TECHNOLOGY THAT IS ICONIC

Every so often in history, the evolution of product technology takes a monumental step forward. ALCO has been pioneering physical measurement since 1900 and along the way studying intensively what comprises an incredible healthcare weighing experience. As result of over a century of research, we introduce you to clinical weighing's new icon®.

ALCO's USA-made icon® represents the next generation of digital clinical measurement. There is nothing equivalent to the icon® on the market!

ALCO's icon® eye-level digital clinical scale has a dual-ranging capacity of 0.2 lb/0.1 kg up to 600 lb/300 kg and 0.5 lb/0.2 kg up to 1,000 lb/500 kg. The low-profile 17 in W x 17 in D platform is nearly flat at only 1.5 inches high. The AL-83909 includes a non-medical grade standard AC adapter or can be powered by 12 AA batteries (not included). The touchless sonar height rod allows you to simply step on the scale and within seconds weight, height, and Body Mass Index will all be displayed onscreen without touching a single key.



ALCO's USA-made apex® scales measure weight and height efficiently on patients of all ages and sizes.



ALCO's USA-made icon® scale assembles easily in seconds right out of the box without the use of any tools. The sonar height rod plugs easily into the back of the column and is held in place securely via a clip on the indicator and the receiving port on the column.



- Sleek, stylish product design
- Eye-level weight display convenience
- Sturdy column construction
- Made in USA quality is apparent throughout the scale design
- 4 different standard icon® models available to choose from



MULTI-COLOR TOUCHSCREEN DISPLAY

The AL-83909 features a high-tech, smart-phone-style indicator for easy utilization with 7 simple buttons and a multi-color touchscreen LCD display for large readouts.

- 0.9-inch-high, clinical-blue LCD weight digits
- Multi-color touchscreen LCD display
- Displays weight, height, and Body Mass Index onscreen simultaneously
- Automatically locks on weight temporarily for a few seconds in order to easily view and record measurement
- Menu button provides quick access to user-friendly menu settings for scale customization
- Battery power level indication

VERSATILE CONNECTIVITY:

- 1 USB-B port
- HL7 IEEE 11073 compliant (standard)
- Wi-Fi Ethernet models available for wireless EMR/EHR
- Welch Allyn® device connectivity available: CVSM, CSM, and LXI (see models chart on back page)

PATIENT IDs



The icon's brilliant, multi-color touchscreen display and intuitive user-prompted navigation menus provide easy entry of items such as 8-digit numeric patient IDs for EMR/EHR.

AC ADAPTER



ALCO's icon® clinical scale includes 1 USB-B port, integral bubble level, AC adapter is included standard, optional Wi-Fi, and Welch Allyn EMR/ EHR connectivity available.

AUTO LOCKING



When a patient steps on the scale, weight, height, and BMI are all shown onscreen and instantly held on the display for 7 seconds automatically in order for the medical professional to view and record the data.

BATTERIES



The platform cover may be removed for easy cleaning and also to provide access to the battery compartment. The icon® may be powered by 12 AA batteries (not included).

STATE-OF-THE-ART EYE-LEVEL DIGITAL CLINICAL SCALES

icon® EYE-LEVEL DIGITAL SCALES WITH SONAR HEIGHT RODS				
Model	ICON	ICON-WI	ICON-UWA	ICON-LXI
Capacity	600 lb x .2 lb / 1000 lb x .5 lb 300 kg x .1 kg / 500 kg x .2 kg			
Height Rod	Touchless sonar height rod			
Height Rod Measures	24" (2') - 86" (7'2") x 0.2 in / 60 cm - 218 cm x 0.5 cm			
DIMENSIONS	Overall Dimensions	17 in W x 18.5 in D x 89.5 in H / 43 cm W x 47 cm D x 227.3 cm H		
	Platform Size	17 in W x 17 in D x 1.5 in H / 43.2 cm W x 43.2 cm D x 3.8 cm H		
POWER	LCD	.9 in / 2.3 cm H LCD digits		
	Batteries	12 AA batteries (not included)		
	AC Adapter (included)	•	•	•
	Ports	1 RS232 serial port and 1 USB-B port		
	Connectivity	Wi-Fi Ethernet	Welch Allyn CVSM/CSM	Welch Allyn LXI
	Net Weight	22 lb / 10 kg		
	Shipping Weight	31 lb / 14 kg		
	Shipping Dimensions	58 in x 20 in x 6 in / 147 cm x 51 cm x 15 cm		
	UPC Code	809161198805	809161198904	809161199000
			809161199000	809161199109

ALCO reserves the right to improve, enhance, or modify features and specifications without prior notice.



AL-83909

www.alcosales.com

6851 High Grove Blvd., Burr Ridge, IL 60527 USA
Ph: 630-655-1900 or 800-323-4282 Fax: 800-950-1167

Mobile: 800.323.4282



ALCO®

Sales & Service Co.



THE POWER + BENEFITS OF ALCO's

SONAR HEIGHT MEASUREMENT

The new sonar digital height sensor, included with ALCO's model AL-83909 scale, is unique in the clinical industry and extremely reliable for accurate, repeatable height measurement, saving time for your day-to-day operations and hygienic, no-touch cleanliness for infection control.



TIME:

When your patient stands on the AL-83909, you are provided with height and weight readouts instantaneously. There is no height rod spoon to position on the top of the patient's head and no keys to touch!



ACCURACY:

The sonar height rod provides accurate readings in 0.2-inch increments. Additionally, the AL-83909 offers up to 1,000-lb capacity readings for bariatric weighing.



HYGIENE:

With the AL-83909 model you don't need to touch a single key when measuring, simply stand on the platform and your readout appears within a second! Hands-free weight and height detection aids in infection control and limiting the spread of bacteria and microbes.

Just when you thought your scale solution was in place, ALCO now offers the ability to manage patient information even better by saving time... providing higher accuracy... and facilitating a much cleaner method of patient measurement.

EVERYONE IS A CUSTOMER

Already have scales in your clinical facility? They probably don't have sonar height rods, so now is the time to consider upgrading your patient measurement to the APEX and AL-83909 for these labor-saving and infection control benefits.



WEIGHT AND HEIGHT INSTANT READOUTS WITHOUT PUSHING A SINGLE BUTTON

Sonar touchless height rods available on icon and some apex® models provide instant digital readouts for optimal speed, accuracy, and hygiene.



Call!



AL-83909



STATE-OF-THE-ART, USA-MADE STAND-ON OR WHEELCHAIR WEIGHING

[High weight capacity, packed with features.
Find the scales you need from ALCO!]

FOLD-UP WALL-MOUNT WHEELCHAIR SCALE



Slim 6.6" profile takes up minimal wall space when mounted

Wi-Fi and Ethernet optional

model AL-83345

Two-way, easy access ramp

Platform lip will hold chair securely in place for weighing

Versatile scale allows patients to be weighed in a wheelchair, ordinary chair, or in standing position. Up to 1,000 lb weighing capacity.



icon® DIGITAL COLUMN SCALE

State-of-the-art sonar height rod



Wi-Fi model available for wireless EMR connectivity

Multicolor touchscreen

Weigh and measure without touching a single key. Part of a suite of physician scales to meet any need.

Up to 1,000 lb capacity

Ultra-thin 1.5" platform



model AL-83909

ALCO's American-made scales provide reliable, stress-free weighing for both independent and immobile patients. These accurate, portable scales are available in a variety of easy-to-transport and easy-to-store models.



HEALTHCARE SCALE

QUICK OPERATION GUIDE

AL-83909

1.



If the display is not on, press the Power button to turn on the scale.

2.

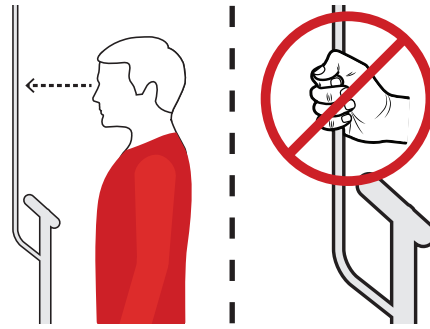

Step on the scale platform and look straight ahead (not down at scale display). Do not touch or hold onto the height rod pole or column and display.

3.



When the weight is stable, a beep will sound and the weight reading will automatically lock and show AUTO LOCK on the display. The weight reading will hold approximately 7 seconds.

NOTE: If more time is needed, press the lock key to hold the locked weight reading.

4.



The scale will also have simultaneously completed measuring your height and calculating your Body Mass Index (BMI).

5.

Read your weight, height and BMI displayed.

BODY MASS INDEX



(800) 323-4282 | info@alcosales.com 6851
High Grove Blvd., Burr Ridge, IL 60527

