

## Technical Data Sheet AL-77552

12" x 14" Framed concealed security mirror

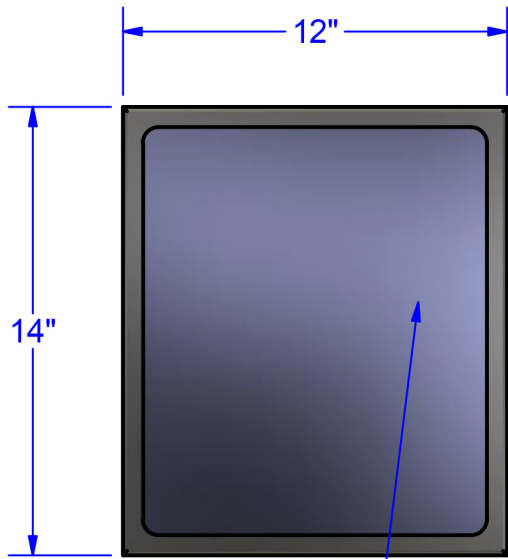

16 gauge #8 polish  
bright stainless steel

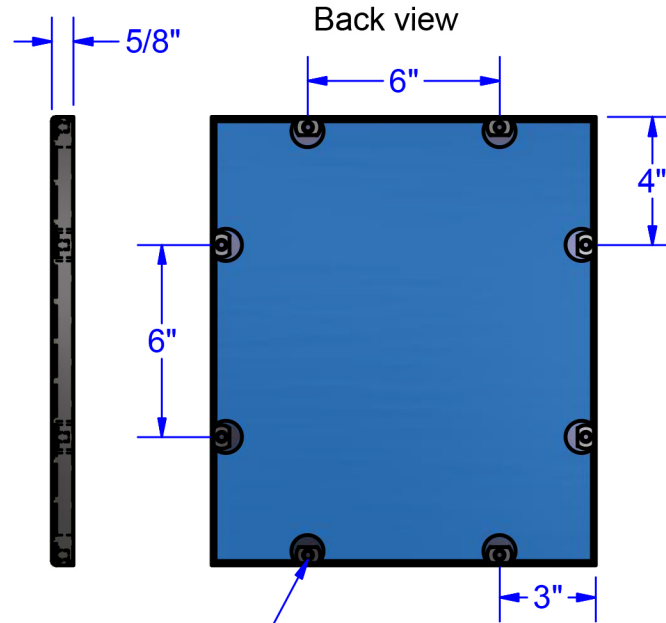

1/4"-20 tee nut  
welded to back of  
mirror, typ. 8x

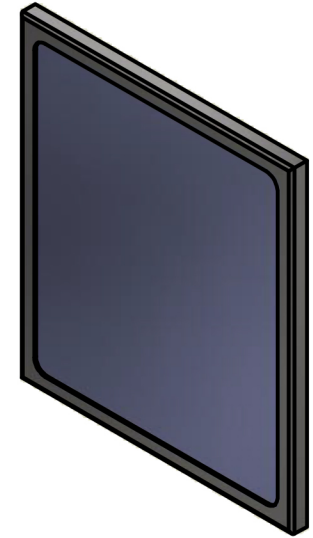

CONSULT LOCAL AND NATIONAL ACCESSIBILITY CODES FOR PROPER INSTALLATION GUIDELINES.  
CONFORMITY AND COMPLIANCE TO LOCAL AND NATIONAL CODES IS THE RESPONSIBILITY OF THE INSTALLER.  
MIRRORS ARE ONLY AS STRONG AS THE ANCHORING DEVICES AND THE WALL ON WHICH IT IS MOUNTED TO.

SPECIFICALLY ENGINEERED TAMPER RESISTANT SECURITY SEALANT MUST BE USED ON ALL WALL JOINTS.

### Construction:

Frame: Seamless 18 gauge type 304 stainless steel angle frame.  
Concealed mounting with 1/4"-20 tee nuts welded to back of mirror.  
Satin #4 finish.  
Mirror: 16 gauge polish #8 bright type 304 stainless steel.  
Backing: 1/2" thick high density solid poly fixed to back of mirror.  
Tee nuts: 1/4"-20 stainless steel. Welded to back of mirror.

### Installation:

Note: Access behind wall is required.  
- Mark hole locations (confirm with each mirror).  
- Drill 5/16" diameter holes.  
- Assemble 1/4"-20 wall studs (not included) into tee-nuts.  
- Insert wall studs on mirror through drilled holes. Tighten with washer and nut evenly. Do not over tighten.  
- Remove white protective vinyl coating.  
Wall stud length requirements: Wall thickness + 5/16"

### Specifications:

12" x 14" Height concealed mount security mirror.  
Angle frame is constructed from 18 gauge type 304 stainless steel.  
Mirror is 16 gauge type 304 stainless steel polished #8 bright.  
Framed seamless corners.