

# AL-69099

## High Capacity Digital Stretcher Scale with Wireless Transmission

**EMR integrated**



- Network-capable with 360° wireless technology.
- Spacious platform for all common stretchers.
- Two integrated fold-away ramps included.
- Mobile thanks to the to casters and integrated handles.
- Innovative memory function for determining precise weight of patient.

## Precision weighing in all situations.

**E**mergency admission into a hospital – everything must happen very quickly, especially when an operation is necessary and the patient's weight needs to be determined in order to ensure the correct dose of anesthetic. Weighing patients on stretchers or gurneys in this or in less dramatic situations is no problem with the AL-69099: the platform is large enough for most common gurneys or stretchers on undercarriages. And, of course, patients can also be weighed comfortably on a chair or in a wheelchair with this platform scale. The AL-69099 is thus suitable for use in the dialysis sector, long term care and in nursing homes.



### Stable construction with very high capacity.

Thanks to its extremely stable construction and very high capacity of 800 lbs / 360 kg, even heavyweight patients can be weighed easily with the platform AL-69099. The platform is generously sized to cope with wheelchairs and most common stretchers on undercarriages.

### Cable remote display with many additional functions.

A cable remote display with easy-to-read LCD figures is included in delivery. This display is operated intuitively and is equipped with many additional functions. With the pre-TARE function, the extra weight of a stretcher or wheelchair can be deducted directly from the total weight during the weighing process. With the BMI function, the nutritional condition of the patient can be determined.

### Paperless and error-free wireless transmission of measurements.

With the 360° wireless technology the AL-69099 can transmit measurements to the optional 360° wireless digital printer. With the network-capable analytics software and USB adapter, your PC can receive and analyze measurements. The AL-69099 is EMR-integrated and ready to handle all the demands the future will bring.

### Casters and integrated handles for transport.

The AL-69099 is a very versatile scale as it is easy to move around on its smooth-running casters with the aid of the integrated handles.

*With its transport casters and steering caster, the AL-69099 can be maneuvered easily.*

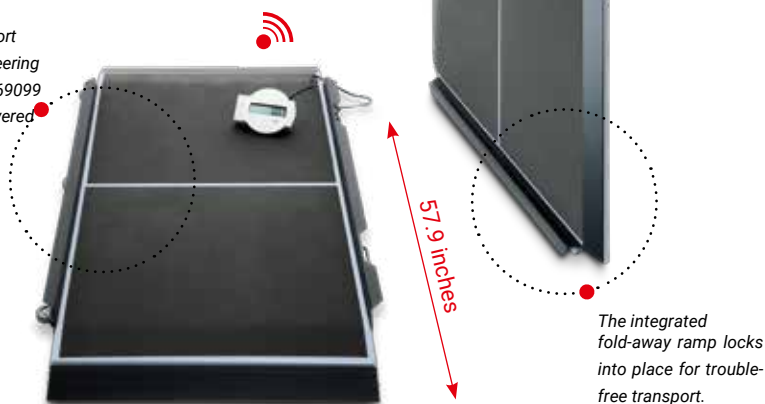

*The integrated fold-away ramp locks into place for trouble-free transport.*

## AL-69099

### Technical Data

- Capacity: 800 lbs / 360 kg
- Graduation: 0.1 lbs / 50 g
- Dimensions (WxHxD):  
35.2 x 3.4 x 65.2" / 893 x 87 x 1,655 mm
- Dimensions platform (WxHxD):  
31.5 x 2.2 x 57.7" / 800 x 55 x 1,465 mm
- Weight: 101.9 lbs / 46.2 kg
- Functions: TARE, pre-TARE, HOLD, auto-HOLD, BMI, auto-CLEAR, lbs/kg switch-over, damping, SEND/PRINT
- Power supply: Power adapter
- Optional: stand for cable remote display
- Included: Two fold-away ramps
- System compatible with: 360° wireless digital printer advanced, 360° wireless digital printer, 360° wireless USB adapter, software analytics and emr flash, stadiometers
- RS232 compatible