

FEATURES:

- **Top-Tite[®] Hinges**
Seat installs easily from above the bowl

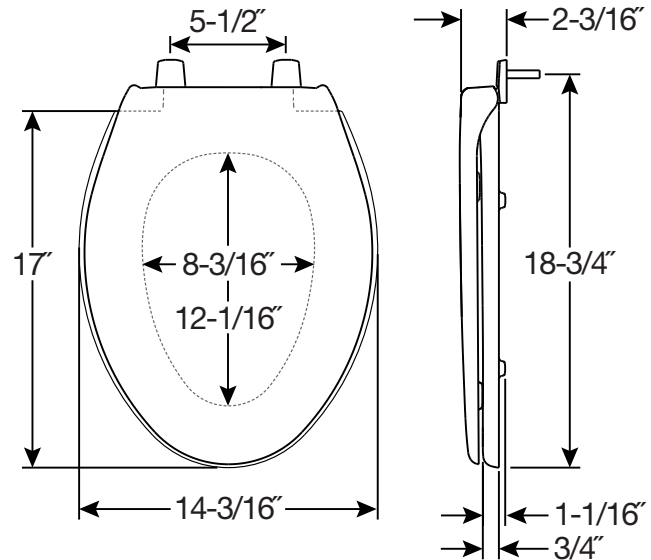

SPECIFICATIONS:

Size: Elongated

Material: Plastic

Style: Closed Front with Cover

Ring Bumpers: Four

Hinges: Plastic

Hardware: Non-Corroding Hex-Tite[™] Bolts and Wing Nuts

Codes & Standards:



Complies with
IAPMO/ANSI Z124.5
Performance Standards
Heavy-Duty Commercial



Proudly Made in the USA

Eco-Friendly

