

HEAVY DUTY DOUBLE TOWEL BAR

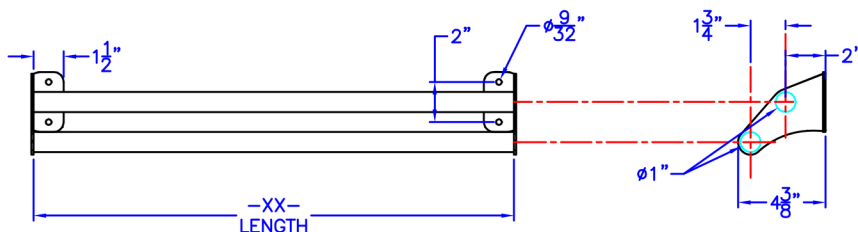
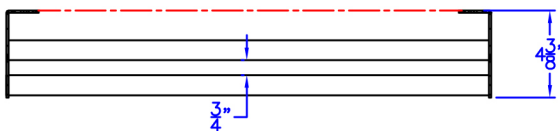
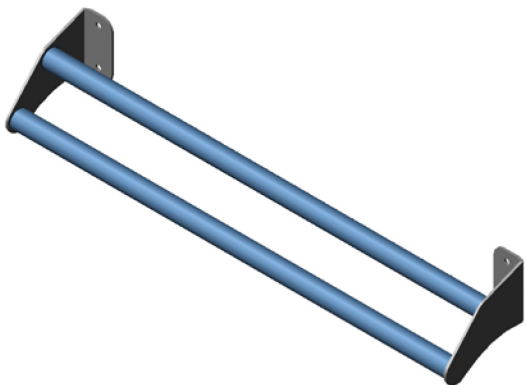

Construction:

TUBES: 1" X .065WALL TYPE 304 STAINLESS STEEL.
 BRACKET: 11 GAUGE TYPE 304 STAINLESS STEEL WITH (2) $\frac{9}{32}$ " MTG. HOLES.
 FINISH: SATIN #4

Installation:

USE BRACKETS AS TEMPLATES TO LOCATE AND MARK HOLES.
 DRILL HOLES FOR APPROPRIATE WALL ANCHORS.
 FASTEN TO WALL (FASTENERS ARE NOT INCLUDED)

CAUTION: TOWEL BAR IS ONLY AS STRONG AS THE ANCHORING DEVICES AND THE WALL ON WHICH IT IS MOUNTED TO.

Guide Specification:

1" ϕ X .065WALL STAINLESS STEEL HEAVY DUTY DOUBLE TOWEL BAR.
 ONE PIECE WELDED CONSTRUCTION.
 EXPOSED MOUNTING.
 SATIN #4 FINISH.